



 **SANYUAN**

专业从事温度保险丝生产35年  
Specialized in producing thermal fuse for over 35 years

      CB ROHS REACH

[www.shanghaixinyuan.com](http://www.shanghaixinyuan.com)

# RH系列

## 构造

### DIMENSIONAL DRAWING

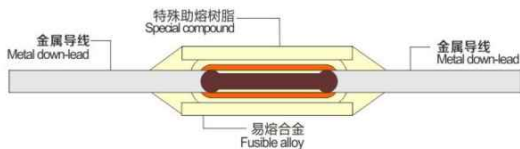

## 尺寸图

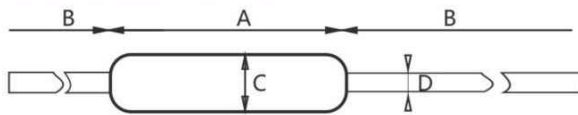

### DIMENSIONAL DRAWING



| 规格标准/Specification and Standard ( mm ) |        |              |          |         |
|--|--------|--------------|----------|---------|
|  | A      | B            | C        | D       |
| 标准引线<br>Standard Lead Wire             | 15±0.5 | 43±3         | Φ4.6±0.2 | Φ1±0.02 |
|  |        | 可调整 adjusted |          |         |

## 表示图

### PRESENTATION DRAWING

 **SANYUAN** \_\_\_\_\_ 商标  
 Trade mark  
 RHxxx \_\_\_\_\_ 型号  
 Model  
 TF XXX°C \_\_\_\_\_ 额定动作温度  
 Rated operating temperature  
 250V 10A \_\_\_\_\_ 额定电压、额定电流  
 Rated voltage/Rated current  
 \_\_\_\_\_ 电气用品认可标记  
 Approved mark for electrical appliance

## 热熔断体动作原理

### STRUCTURE AND OPERATING THEORY

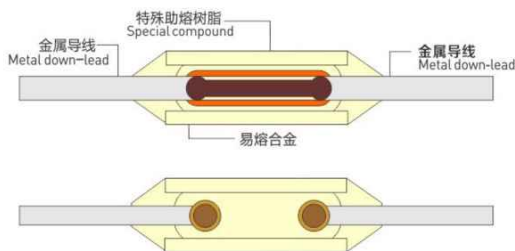

RH系列热熔断体周围温度上升到它的动作温度时，其易熔合金融化并在表面张力及特殊树脂帮助作用下，

易熔合金丝断开并收缩成球状附在两引脚末端。这样，电路被永久性切断。

When the external temperature reaches operating temperature, fusible alloy would be melted.

With the help of surface tension and the special compound, the fusible alloy would be disconnected and shrank to two terminals of down-lead foot. Thus, circuit would be cut forever.



## 额定表

### RATED FORM

"TF" 额定动作温度 / Rated Functioning Temperature

"TO" 实际动作温度 / Operating Temperature

"TC" 保持温度 / Holding Temperature

"TM" 极限温度 / Maximum Temperature Limit

| 型号<br>Model Rated | TF °C | TO °C | TH °C | TM °C | 额定电流<br>Rated current | 额定电压<br>Rate dvoltage | 通过认证<br>Pass certification  |
|-------------------|-------|-------|-------|-------|-----------------------|-----------------------|---|
| RH150             | 150   | 145±5 | 110   | 200   | 10A                   | 250V                  |  |
| RH185             | 180   | 180±5 | 145   | 250   |                       |                       |   |
| RH200             | 200   | 195±5 | 150   | 250   |                       |                       |   |
| RH230             | 230   | 225±5 | 190   | 280   |                       |                       |   |
| RH250             | 250   | 240±5 | 227   | 300   |                       |                       |   |
| RH320             | 320   | 310±5 | 250   | 350   |                       |                       |   |

## 参数

### ELECTRIC PARAMEMETER

Rated voltage

额定电压：250V，AC

Rated current

额定电流：10A

Frequency

频率：50 or 60HZ

Maximum quantity of electricity allowed

最大允许插入电流：250V,AC 10A